

## R602.10 Code and Commentary for 2012 NC Residential Code – final 03/06/13

*Commentary italicized and printed in red*

- 1. Section R602.10 -- provides charging language for two simplified bracing approaches (isolated panel and continuously sheathed), an engineered approach, the IRC 2012 provisions and APA SR-102.*
- 2. Section R602.10.1 – provides bracing methods and materials common to both simplified methods and is non-exclusive.*
- 3. Section R602.10.2 – simplified isolated panel bracing (for low wind only, 90 and 100 mph)*
- 4. Section R602.10.3 – simplified continuous bracing (for up to 110 mph, wind); this could be expanded to 130 mph.*
- 5. Section R602.10.4 – provides engineering approach that would be applicable to any wind zone within scope; provides means of engineering consistent with NCBC bracing provisions to promote competitive value of engineered solutions in a manner exactly equivalent to the NCBC.*
- 6. Section R602.10.5 – provides various load path details applicable to any prescriptive method important to overall building performance and connectivity for any bracing method.*

**R602.10 Wall bracing.** Buildings, and portions thereof, shall be braced in accordance with one or more of the following sections using bracing materials and methods complying with Section R602.10.1 and load path detailing in accordance with Section R602.10.5:

1. Isolated panel bracing per Section R602.10.2,
2. Continuous sheathing per Section R602.10.3,
3. Engineered design per Section R602.10.4, or
4. 2012 International Residential Code (IRC).
5. SR-102 as published by APA, The Engineered Wood Association with limitations indicated in this document. Note: Code references in SR-102 are referencing the 2012 IRC.

*The selected bracing method or combination of methods is at the option of the permit holder and not the inspections department. R602.10 items 1 and 2 are prescriptive and do not require the seal of a registered professional.*

Where a building, or portion thereof, does not comply with Section R602.10.2, Section R602.10.3, or Section R602.10.5, those portions shall be designed and constructed in accordance with Section R602.10.4.

**R602.10.1 Bracing materials and methods.** Wall bracing materials and methods shall comply with Table R602.10.1.

*Table R602.10.1 catalogs materials and bracing methods used in the prescriptive methods of section R602.10.2 (isolated panel method) and section R602.10.3 (continuous sheathing method). Any of these methods may be used for engineered solutions at the discretion of the designer. When using the prescriptive methods the type of bracing will be selected by the permit holder.*

**Table R602.10.1**  
**BRACING METHODS<sup>1,2</sup>**

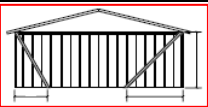
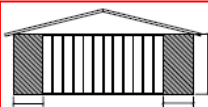
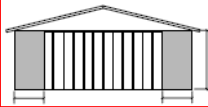
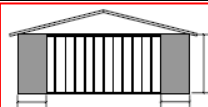
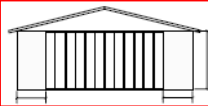
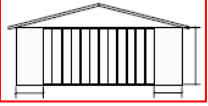
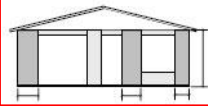
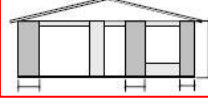
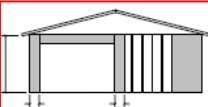
<u>Method</u>	<u>Minimum Brace Material Thickness or Size</u>	<u>Minimum Brace Panel Length or Brace Angle</u>	<u>Connection Criteria</u>		<i>Illustration of Bracing Method (illustrates method only, not location)</i>
			<u>Fasteners</u>	<u>Spacing</u>	
<u>LIB</u> <u>Let-in Bracing</u>	1x4 wood brace (or approved metal brace installed per manufacturer instructions)	45° angle for maximum 16" oc stud spacing <sup>3</sup>	2-8d common nails or 3-8d (2-1/2" long x 0.113" dia.) nails	Per stud and top and bottom plates	
<u>DWB</u> <u>Diagonal wood boards</u>	3/4" (1" nominal)	48"	2-8d (2-1/2" long x 0.113" diameter) or 2 – 1-3/4" long staples	Per stud and top and bottom plates	
<u>WSP</u> <u>Wood structural panel</u>	3/8"	48" <sup>4</sup>	6d common nail or 8d (2-1/2" long x 0.113" diameter) nail <i>See Table R602.3(3)</i>	6" edges 12" field	
<u>SFB</u> <u>Structural Fiberboard Sheathing</u>	1/2"	48" <sup>4</sup>	1-1/2" long x 0.120" dia. Galvanized roofing nails	3" edges 6" field	
<u>GB</u> <u>Gypsum Board Installed on both sides of wall</u>	1/2"	96" for use with R602.10.2 48" for use with R602.10.3	Min. 5d cooler nails or #6 screws	7" edges 7" field	
<u>PCP</u> <u>Portland cement plaster</u>	3/4" (maximum 16" oc stud spacing)	48"	1-1/2" long, 11 gage, 7/16" diameter head nails or 7/8" long, 16 gage staples	6" o.c. on all framing members	
<u>CS-WSP<sup>5</sup></u> <u>Continuously sheathed WSP</u>	3/8"	24" adjacent to window not more than 67% of wall height; 30"	Same as WSP	Same as WSP	
<u>CS-SFB<sup>5</sup></u> <u>Continuously sheathed SFB</u>	1/2"	adjacent to door or window greater than 67% and less than 85% of wall height. 48" for taller openings.	Same as SFB	Same as SFB	
<u>PF</u> <u>Portal Frame<sup>6</sup></u>	7/16"	See Figure R602.10.1	See Figure R602.10.1	See Figure R602.10.1	

**Table Notes:**

1. Alternative bracing materials and methods shall comply with Section 105 of the North Carolina Administrative Code and Policies, and shall be permitted to be used as a substitute for any of the bracing materials listed in Table R602.10.1 provided at least equivalent performance is demonstrated. Where the tested bracing strength or stiffness differs from tabulated materials, the bracing amount required for the alternative material shall be permitted to be factored to achieve equivalence.

- All edges of panel-type wall bracing shall be attached to framing or blocking, except GB bracing horizontal joints shall not be required to be blocked when joints are finished.
- Two LIB braces installed at a 60° angle shall be permitted to be substituted for each 45° angle LIB brace.
- For 8-foot or 9-foot wall height, brace panel minimum length shall be permitted to be reduced to 36-inch or 42-inch length, respectively, where not located adjacent to a door opening. A braced wall panel shall be permitted to be reduced to a 32-inch length when studs at each end of the braced wall panel are anchored to foundation or framing below using hold-down device with minimum 2,800 lbs. design tension capacity. For detached single story garages and attached garages supporting roof only, a minimum 24-inch brace panel length shall be permitted on one wall containing one or more garage door openings.

*The 24" braced wall panel length is intended to be located adjacent to the garage door opening.*

- Bracing methods designated CS-WSP and CS-SFB shall have sheathing installed on all sheathable surfaces above, below, and between wall openings.
- For purposes of bracing in accordance with Section R602.10.2, two portal frame brace panels with wood structural panel sheathing applied to the exterior face of each brace panel as shown in Figure R602.10.1 shall be considered equivalent to one braced wall panel.

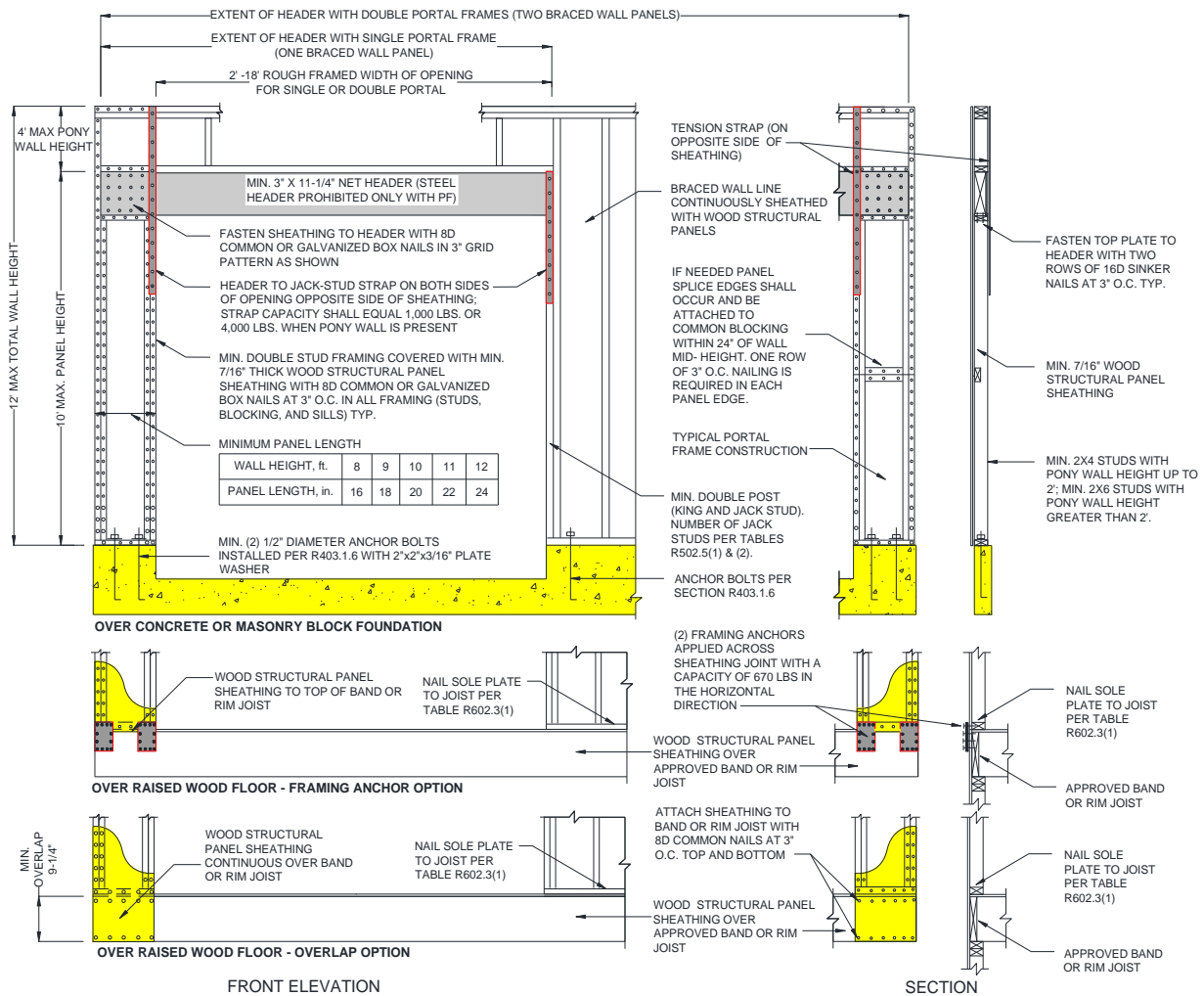

For SI: 1 inch = 25.4 mm, 1 foot = 305 mm, 1 lb = 4.45 N

**Figure R602.10.1**  
**Method PF – Portal Frame Construction**

## **R602.10.2. Isolated Panel Bracing.**

**R602.10.2.1 Limitations.** The conventional bracing requirements of Section R602.10.2.2 shall be limited to the following conditions of use:

1. Basic design wind speed shall not exceed 100 mph, Exposure Category B.
2. Bracing methods shall be LIB, DWB, WSP, SFB, GB, PCP, and PF in accordance with Table R602.10.1.
3. Length of the house is limited to 75 feet. Overall plan length shall not exceed 3 times the overall plan width. The multiple circumscribed rectangle method from R602.10.3.2 may be applied to the method set forth in this section.
4. Wall height at each story level shall not exceed 10 feet.
5. Roof eave-to-ridge height shall not exceed 10 feet unless the roof is considered as an additional story for the purpose of determining bracing amounts required.
6. Except when used for bracing method GB, the interior side of exterior walls and both sides of interior walls shall be sheathed continuously with minimum ½-inch-thick gypsum wall board interior finish fastened in accordance with Table R702.3.5, or approved interior finish of equivalent or greater shear resistance.

*The intent of this provision is to recognize the strength that gypsum wallboard adds to braced wall panels on exterior walls. The gypsum wallboard may be omitted if the length of each braced wall panel without the gypsum board is multiplied by 1.4.*

7. Floors shall not cantilever more than 24 inches (607 mm) beyond the foundation or bearing wall below.
8. Townhouses shall be stabilized independently of adjacent units unless a design is provided to permit lateral load transfer between adjacent units.
9. Townhouses in Seismic Design Category C shall be designed in accordance with Section R602.10.4 or the 2012 IRC.

*See also Figure R301.2(2) and R301.2.2 in 2012 NCRC for counties in Seismic Design Category C.*

**R602.10.2.2 Requirements.** Braced wall panels shall be constructed of bracing methods, materials, and minimum braced panel lengths complying with Table R602.10.1. The number of braced wall panels required for each side of a building (elevation view) at each story level of the building shall comply with Table R602.10.2. The following additional requirements shall apply:

1. In no case shall the amount of bracing be less than two braced wall panels on exterior walls comprising each side of the floor plan (or plan elevation) for each story level of the building.
2. A braced wall panel shall be located within 12 feet of both ends of each elevation view of the house. Braced wall panels on exterior walls shall be installed such that the edge-to-edge distance between braced wall panels does not exceed 21 feet. Refer to Figure R602.10.2.2

*The intent of this section is to allow a 12' distance from each corner of the wall elevation. See Figure CR602.10.2.2(2).*

- No more than one-half of bracing on parallel exterior walls shall be permitted to be relocated to interior walls oriented in the same plan direction and within one-half the floor plan dimension perpendicular to the exterior wall.

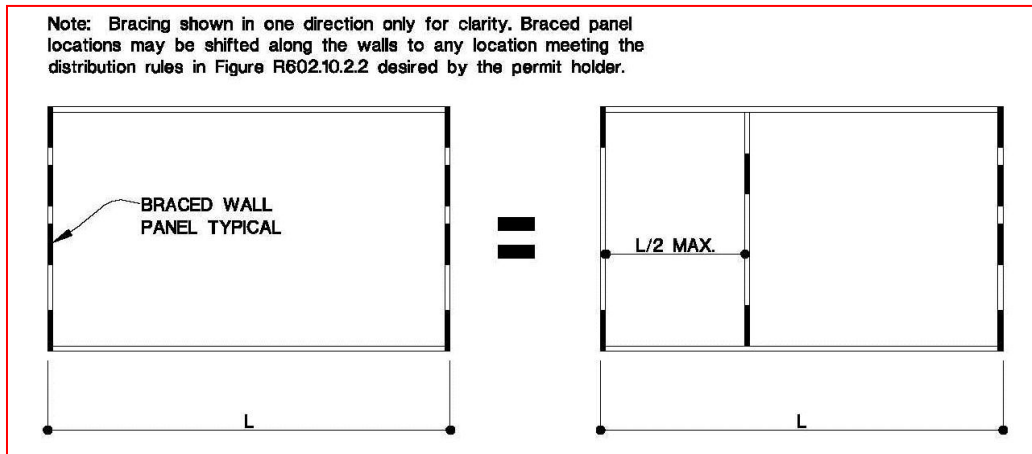

**FIGURE CR602.10.2.2(1) – PANELS SHIFTED TO INTERIOR WALLS**

- Use of multiple bracing methods and materials complying with Table R602.10.1 shall be permitted.
- Detached garages or storage buildings connected to the house with a covered walk-way shall be considered separate buildings. Houses with skewed wings shall be designed in accordance with Section R602.10.3, Section R602.10.4, or the 2012 IRC.
- Garage door openings supporting a floor load above shall be braced using the portal frame method (PF) unless the building plan level containing the garage opening wall complies with all the bracing requirements of this section.

**TABLE R602.10.2**  
**Number of Braced Wall Panels Required**  
**for Each House Elevation (Building Side) at Each Story Level<sup>1</sup>**

Wind Velocity	Story Level Supporting:	Longest Overall Dimension of Floor Plan for a Given Story Level		
		25'	50'	75'
90 mph	Roof Only	<u>1</u>	<u>2</u>	<u>3</u>
	Roof + 1 Story	<u>2</u>	<u>4</u>	<u>6</u>
	Roof + 2 Stories	<u>3</u>	<u>6</u>	<u>9</u>
100 mph	Roof Only	<u>2</u>	<u>3</u>	<u>4</u>
	Roof + 1 Story	<u>3</u>	<u>5</u>	<u>8</u>
	Roof + 2 Stories	<u>4</u>	<u>8</u>	<u>11</u>

1. Interpolation between dimensions is permitted. Extrapolation is prohibited. Fractions of panels shall be rounded to the nearest whole panel.

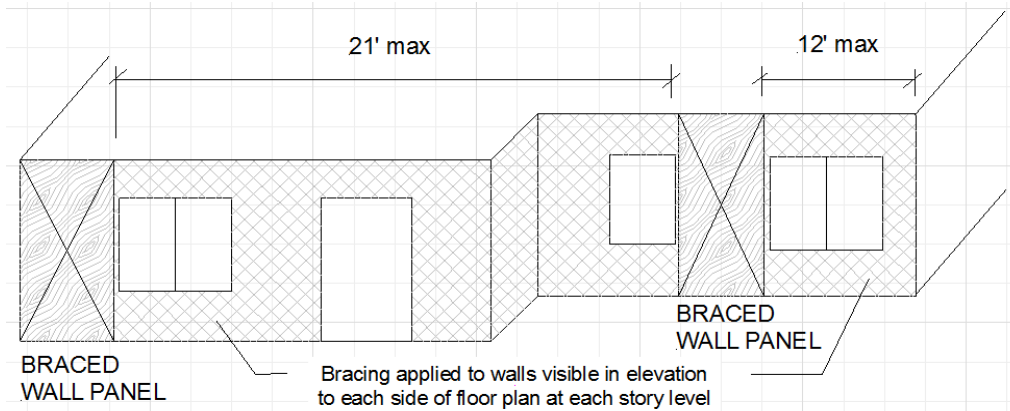
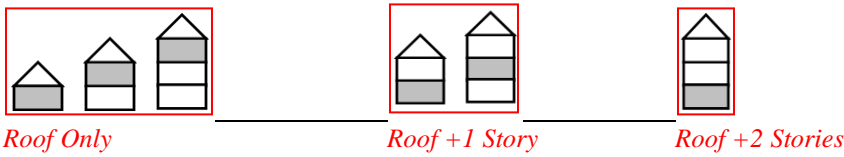

**Figure R602.10.2.2 - Location of Braced Wall Panels**

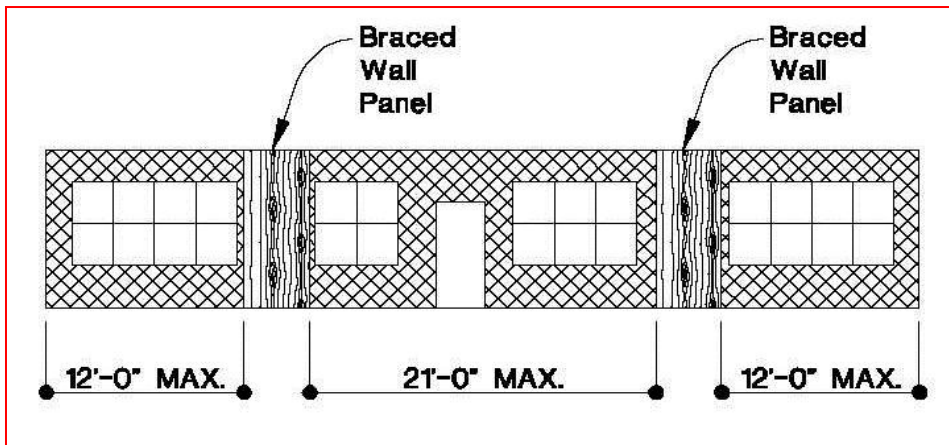

**FIGURE CR602.10.2.2(2) – PANELS MAY BE INSET 12'-0" FROM BOTH ENDS OF WALL ELEVATION**

### **R602.10.3 Continuous Sheathing.**

**R602.10.3.1 Limitations.** The continuous sheathing requirements of Section R602.10.3 shall be limited to bracing methods CS-WSP and CS-SFB in accordance with Table R602.10.1 with the following conditions of use:

1. Basic design wind speed shall not exceed 110 mph.
2. Wall height at each story level shall not exceed 12 feet.
3. Eave to ridge height shall not exceed 20 feet.
4. Exterior walls shall be sheathed on all sheathable surfaces including infill areas between braced wall panels, above and below wall openings, and on gable end walls.
5. Except when used for bracing method GB, the interior side of exterior walls and both sides of interior walls shall be sheathed continuously with minimum ½-inch-thick gypsum wall board interior finish fastened in accordance with Table R702.3.5, or approved interior finish of equivalent or greater shear resistance. Unless required for fire separation by Section R302.6, gypsum board shall be permitted to be omitted where the required length of bracing, as determined in Table R602.10.3, is multiplied by 1.40.
6. Floors shall not cantilever more than 24 inches (607 mm) beyond the foundation or bearing wall below.
7. Townhouses in Seismic Design Category C shall be designed in accordance with Section R602.10.4 or the 2012 IRC.
8. Townhouses shall be stabilized independently of adjacent units, unless a design is provided to permit lateral load transfer between adjacent units.

**R602.10.3.2 Requirements.** The required length of bracing for each side of a rectangle circumscribed around the plan or a portion of the plan at each story level shall be determined using Table R602.10.3 and Figure R602.10.3(1). The cumulative contributing length of braced wall panels assigned to a rectangle side shall be greater than or equal to the required length of bracing specified in Table R602.10.3. The following additional requirements shall apply.

1. Braced wall panels on exterior or interior walls shall be assigned to the nearest rectangle side as shown in Figure R602.10.3(2) for each story level floor plan.
2. Braced wall panels shall be distributed and installed in accordance with Figure R602.10.3(3).
3. A minimum of one-half the required bracing amount for each rectangle side should be located on exterior walls within 8 feet of the location of the rectangle side.
4. Interior braced wall panels using Method GB shall be assigned to the closest parallel rectangle side and shall contribute 0.5 times their actual length.

*The narrowest width of braced wall panels allowed for GB is 48", and the 0.5 accounts for GB being half the strength of other methods except LIB.*

5. The bracing amount provided on an upper story building side shall be deemed-to-comply where it equals or exceeds the amount of bracing required for the story immediately below.
6. Where the bracing amount provided on an upper story equals or exceeds the amount of bracing required for the story below, an analysis of bracing shall not be required for the upper story.

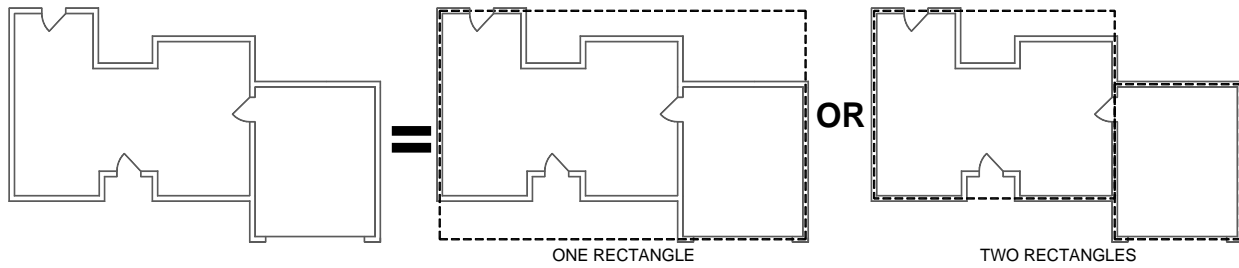

**FIGURE R602.10.3(1)**  
**CIRCUMSCRIBED RECTANGLES**<sup>1,2,3</sup>

**Figure Notes:**

1. Each floor plan level shall be circumscribed with one or more rectangles around the floor plan or portions of the plan at the floor level under consideration as shown in Figure R602.10.3(1).
2. Rectangles shall surround all enclosed offsets and projections such as sunrooms and attached garages for a given story level floor plan. Chimneys, partial height projections, and open structures, such as carports and decks, shall be excluded from the rectangle.

*Examples of partial height projections include but are not limited to bay windows, pre-fab vented fireplaces, etc. Open structures include carports, decks, open and screened porches, etc.*

3. Each rectangle shall have no side greater than 80 feet (24.4 m) with a maximum rectangle length-to-width ratio of 3:1. Rectangles shall be permitted to be skewed to accommodate diagonal walls.



**TABLE R602.10.3**

**REQUIRED LENGTH OF BRACING ALONG EACH SIDE OF A CIRCUMSCRIBED RECTANGLE** <sup>a, b, c, d</sup>

WIND SPEED	EAVE-TO RIDGE HEIGHT (FEET)	STORY LEVEL SUPPORTING: <sup>e</sup>	REQUIRED LENGTH OF BRACING ON ANY SIDE							
			Length of perpendicular side (ft) <sup>f</sup>							
			10	20	30	40	50	60	70	80
90	10	Roof Only	2.0	3.5	5.0	6.0	7.5	9.0	10.5	12.0
		Roof + 1 Story	3.5	6.5	9.0	12.0	14.5	17.0	19.8	22.6
		Roof + 2 Stories	5.0	9.5	13.5	17.5	21.5	25.0	29.2	33.4
	15	Roof Only	2.6	4.6	6.5	7.8	9.8	11.7	13.7	15.7
		Roof + 1 Story	4.0	7.5	10.4	13.8	16.7	19.6	22.9	26.2
		Roof + 2 Stories	5.5	10.5	14.9	19.3	23.7	27.5	32.1	36.7
	20	Roof Only	2.9	5.2	7.3	8.8	11.1	13.2	15.4	17.6
		Roof + 1 Story	4.5	8.5	11.8	15.6	18.9	22.1	25.8	29.5
		Roof + 2 Stories	6.2	11.9	16.8	21.8	27.3	31.1	36.3	41.5
100	10	Roof Only	2.5	4.0	6.0	7.5	9.5	11.0	12.8	14.6
		Roof + 1 Story	4.5	8.0	11.0	14.5	18.0	21.0	24.5	28.0
		Roof + 2 Stories	6.0	11.5	16.5	21.5	26.5	31.0	36.2	41.4
	15	Roof Only	3.4	5.2	7.8	9.8	12.4	14.3	16.7	19.1
		Roof + 1 Story	5.2	9.2	12.7	16.7	20.7	24.2	28.2	32.2
		Roof + 2 Stories	6.6	12.7	18.2	23.7	29.2	34.1	39.8	45.5
	20	Roof Only	3.8	5.9	8.8	11.1	14.0	16.2	18.9	21.6
		Roof + 1 Story	5.9	10.4	14.4	18.9	23.4	27.3	31.8	36.3
		Roof + 2 Stories	7.5	14.4	20.6	26.8	33.0	38.5	44.9	51.3
110	10	Roof Only	3.0	4.8	7.3	9.1	11.5	13.3	15.5	17.7
		Roof + 1 Story	5.5	10.0	13.3	17.5	21.8	25.4	29.6	33.8
		Roof + 2 Stories	7.5	13.9	20.0	26.0	32.1	37.5	43.8	50.1
	15	Roof Only	4.2	6.3	9.5	11.9	15.0	17.3	20.2	23.1
		Roof + 1 Story	6.3	11.2	15.4	20.2	25.0	29.3	34.2	39.1
		Roof + 2 Stories	8.0	15.4	22.0	28.7	35.3	41.3	48.2	55.1
	20	Roof Only	4.6	7.2	10.6	13.4	16.9	19.6	22.9	26.2
		Roof + 1 Story	7.2	12.6	17.4	22.9	28.3	33.0	38.5	44.0
		Roof + 2 Stories	9.1	17.4	24.9	32.4	39.9	46.6	54.4	62.2

For SI: 1 ft = 304.8 mm



*Roof Only*

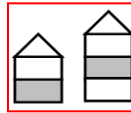

*Roof + 1 Story*



*Roof + 2 Stories*

- <sup>a</sup>. Interpolation shall be permitted; extrapolation shall be prohibited.
- <sup>b</sup>. For Exposure Category C or D, multiply the required length of bracing by a factor of 1.3 or 1.6, respectively.
- <sup>c</sup>. For wall heights other than 10 ft (3048 mm), multiply the required length of bracing by the following factors: 0.90 for 8 feet (2438 mm), 0.95 for 9 feet (2743 mm), 1.05 for 11 feet (3353 mm) and 1.10 for 12 feet (3658 mm).
- <sup>d</sup>. Where minimum ½" gypsum wall board interior finish is not provided, the required bracing amount for the affected rectangle side shall be multiplied by 1.40.
- <sup>e</sup>. A floor, habitable or otherwise, contained wholly within the roof rafters or roof trusses need not be considered a story for purposes of determining wall bracing provided the

eave to ridge height does not exceed 20 feet and the openings in the roof do not exceed 48 inches in height.

- f. Perpendicular sides to the front and rear sides are the left and right sides.  
Perpendicular sides to the left and right sides are the front and rear sides.

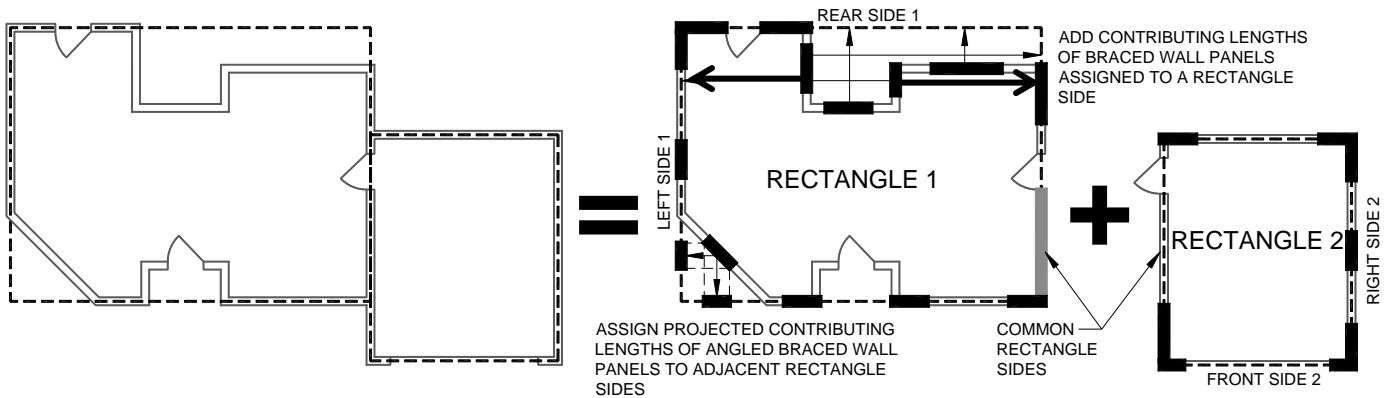

(a) Regular Floor Plan

**FIGURE R602.10.3(2)a**

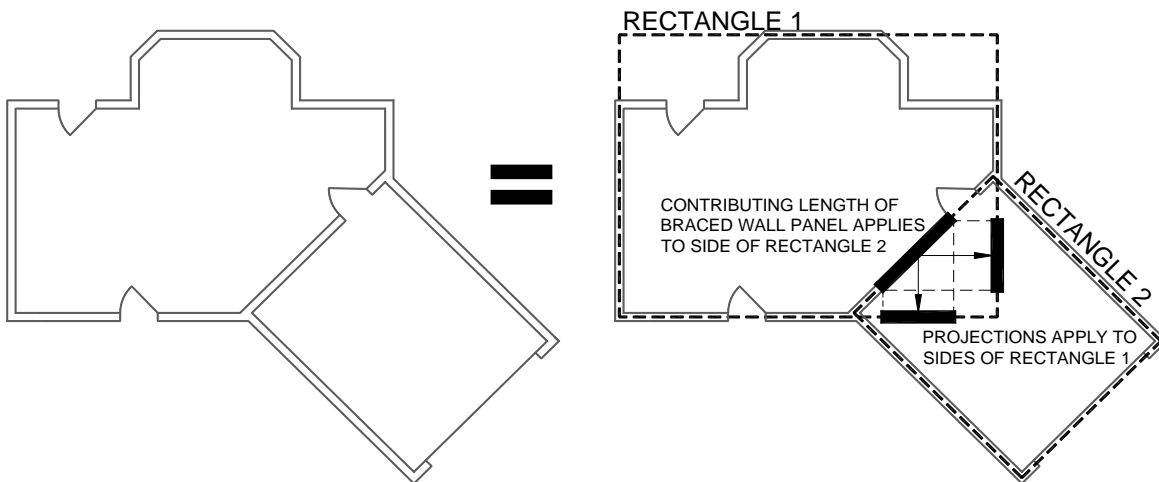

(b) Skewed Floor Plan

**FIGURE R602.10.3(2)b**

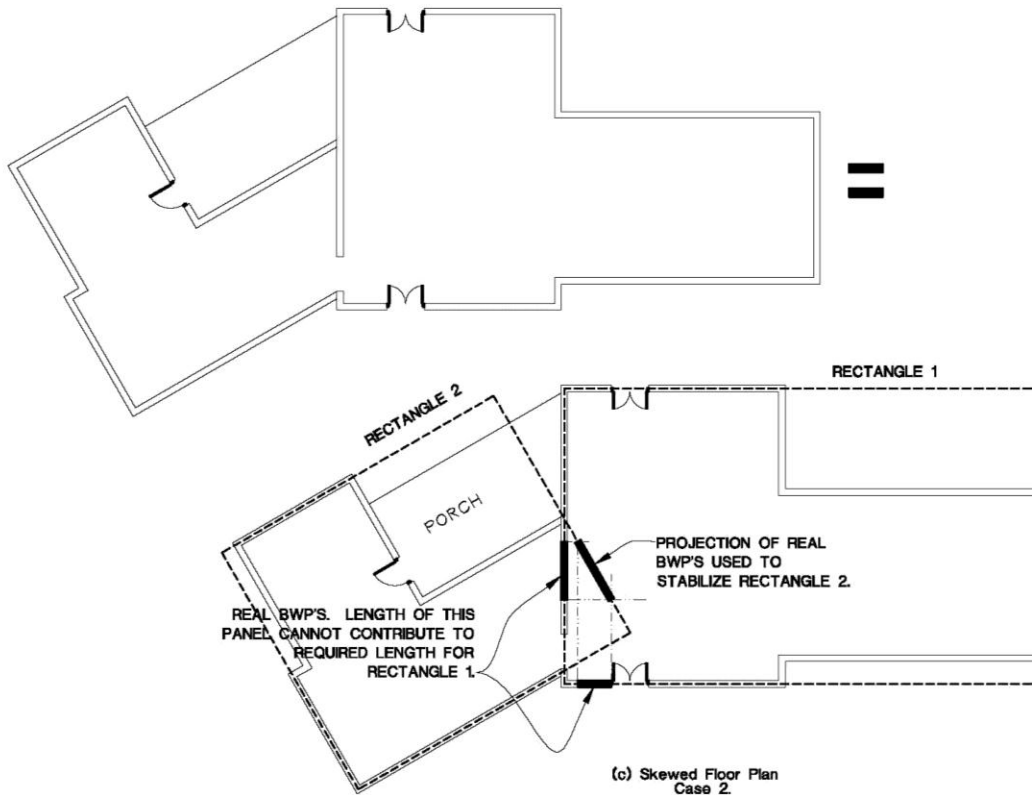

**FIGURE R602.10.3(2)c**

**FIGURE R602.10.3(2) Notes**

**ASSIGNMENT OF BRACED WALL PANELS TO CIRCUMSCRIBED RECTANGLE SIDES<sup>1,2,3,4,5,6</sup>**

**Figure Notes:**

1. Exterior braced wall panels shall be assigned to the closest parallel rectangle side and shall contribute their actual length.
2. Interior braced wall panels using Method GB shall be assigned to the closest parallel rectangle side and shall contribute 0.5 times their actual length.
3. Projected contributing lengths of angled braced wall panels shall be assigned to the closest rectangle sides.
4. Portal frame braced wall panels shall contribute 1.5 times their actual length to their assigned rectangle side.
5. Where multiple rectangles share a common side or sides, as shown in Figure R602.10.3(2)(a), the required length of bracing shall equal the sum of the required lengths from each of the shared rectangle sides.
6. Braced wall panels located on a common wall where skewed rectangles intersect, as shown in Figure R602.10.3(2)(b), shall have their contributing length applied towards the required length of bracing for the parallel rectangle side and its projected contributing lengths towards the adjacent skewed rectangle sides. Where the common side of rectangle 2 as shown in Figure R602.10.3(2)c has no physical wall, the wall bracing required to stabilize this side of Rectangle 2 shall be determined from Table 602.10.3. This length of bracing shall be resolved into orthogonal projections, and the orthogonal projections shall be added to the length of bracing required for the walls of Rectangle 1 which connect to Rectangle 2 in the directions parallel to the projections.

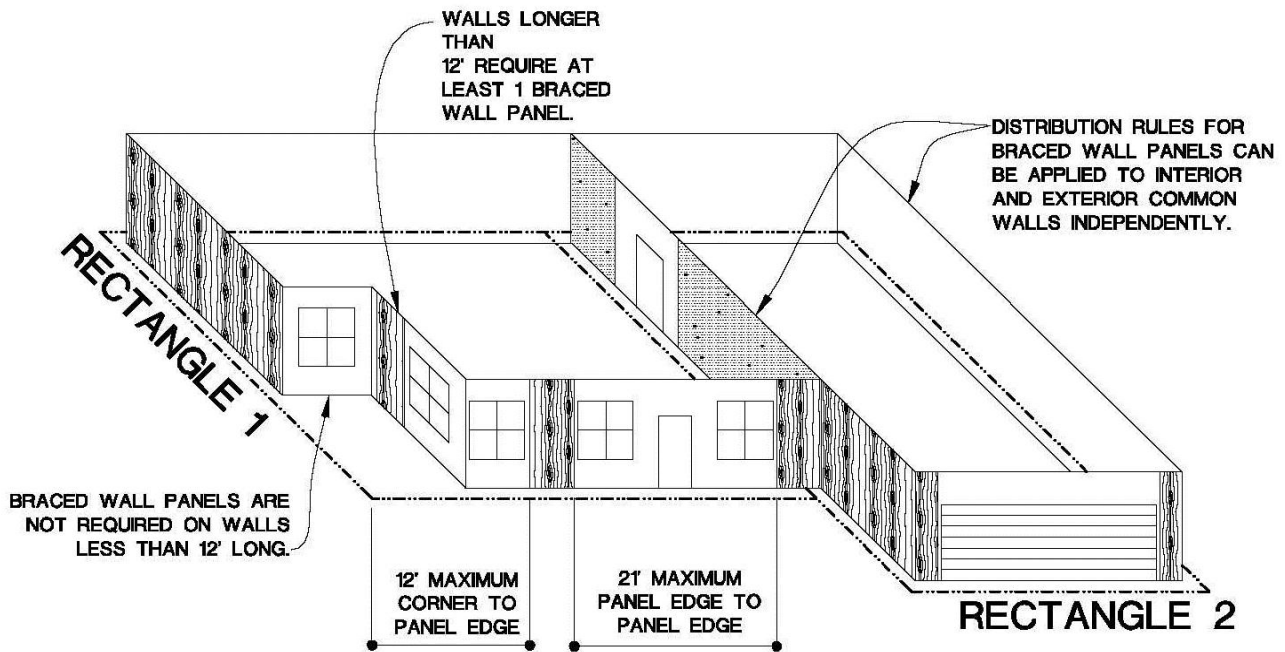

For SI: 1 ft = 304.8 mm

**FIGURE R602.10.3(3)**  
**DISTRIBUTION OF BRACED WALL PANELS<sup>1,2,3,4,5</sup>**

**Figure Notes:**

1. A braced wall panel shall be located on each elevation view within 12 feet of the corners of circumscribed rectangles. Detached garages or storage buildings connected to the house with a covered walk-way shall be considered separate buildings.
2. The distance between adjacent edges of braced wall panels shall be no more than 21 feet (6096 mm).
3. Segments of exterior walls greater than 12 feet (2438 mm) in length shall have a minimum of one braced wall panel.
4. Segments of exterior wall 12 feet (2438 mm) or less in length shall be permitted to have no bracing provided a braced wall panel is located within 12 feet from the rectangle corner.
5. Interior and exterior wall segments which contribute to the common sides of multiple rectangles shall be permitted to apply the distribution requirements given above to each wall segment independently.

*See Figures CR602.10.3(4)a and CR602.10.3(4)b for end conditions for braced walls with continuous sheathing.*

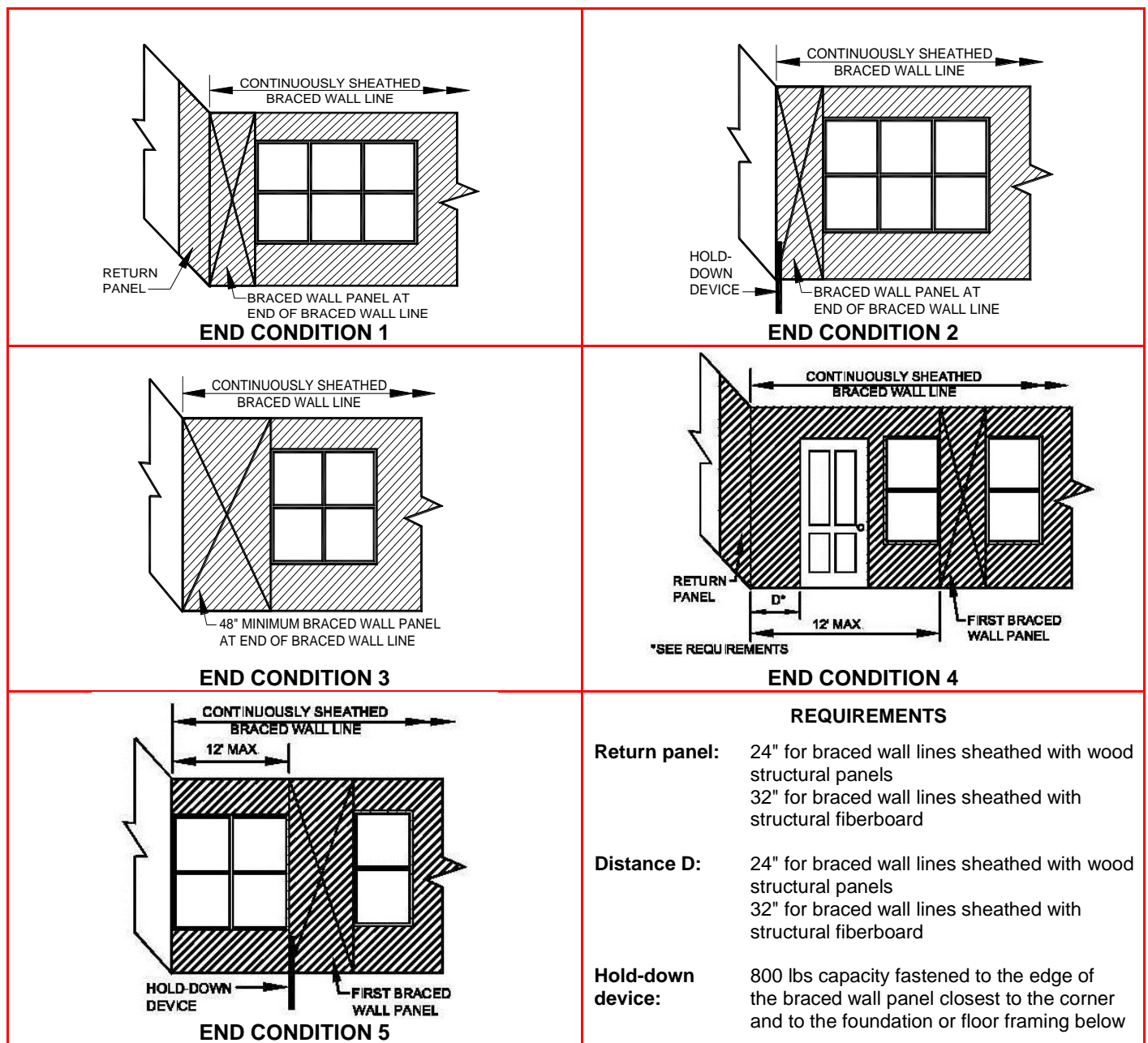

**FIGURE CR602.10.3(4)a**  
**END CONDITIONS FOR BRACED WALLS WITH CONTINUOUS SHEATHING**

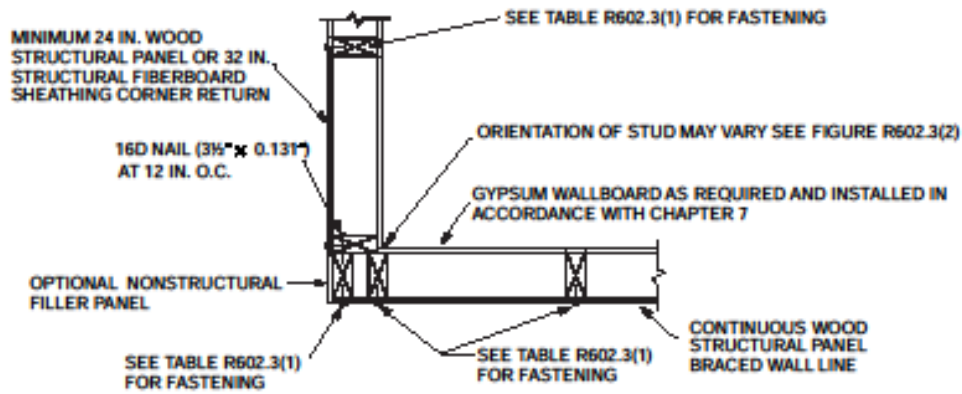

(a) OUTSIDE CORNER DETAIL

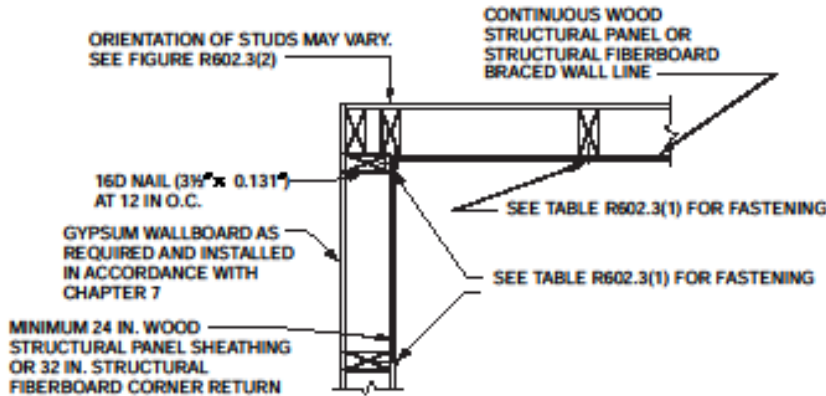

(b) INSIDE CORNER DETAIL

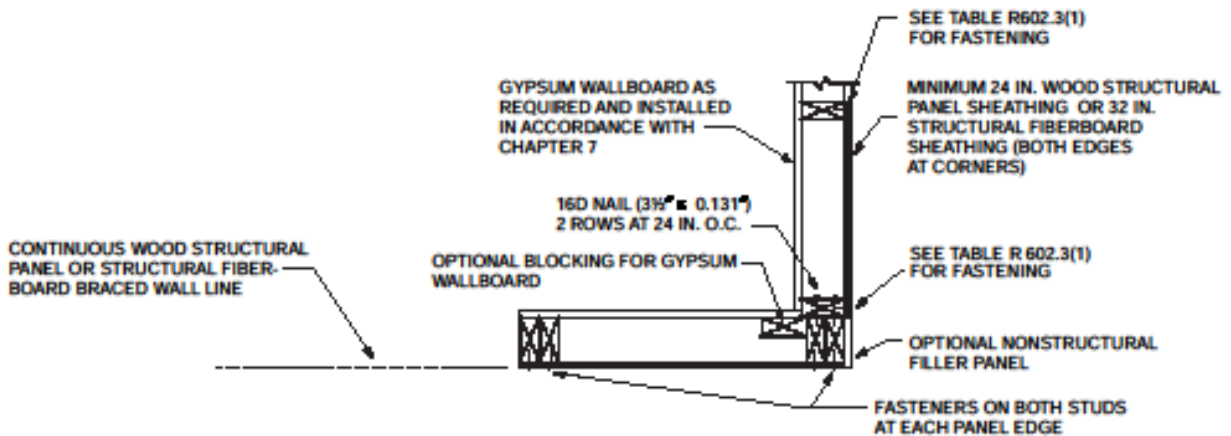

(c) GARAGE DOOR CORNER

For SI: 1 inch = 25.4 mm, 1 foot = 305 mm.

**FIGURE CR602.10.3(4)b**  
**TYPICAL EXTERIOR CORNER FRAMING FOR CONTINUOUS SHEATHING**

**R602.10.4 Wall bracing by engineered design.** Design using bracing materials and methods listed in Table R602.10.1 or approved alternative materials and methods shall be permitted and shall comply with accepted engineering practice. Accepted engineering practice shall include the following:

1. Design in accordance with Section R301.
2. Design equivalent to the analysis basis of the provisions in Sections R602.10.2, R602.10.3, and R602.10.5, including determination of design loads, design unit shear values, and bracing amounts<sup>1</sup>.

**R602.10.5 Load path details.** Construction shall comply with applicable detailing requirements of this section to ensure an adequate continuous load path for transfer of bracing loads and uplift loads from the roof to the foundation.

**R602.10.5.1 Wind Uplift Load Path.** Framing connections to transfer roof uplift forces shall comply with Section R602.3.5 and Section R802.11. In the 110 mph wind zone provide uplift anchorage in accordance with Sections R4508 and Section R4504.1.

**R602.10.5.2 Foundation Anchorage.** Braced wall panels shall be connected to the foundation per Section R403.1.6 and as required in Figure R602.10.1 for portal frames.

**R602.10.5.3 Masonry or Concrete Pedestals.** Masonry or concrete stem walls with a length of 48 inches (1220 mm) or less supporting braced wall panels shall be reinforced in accordance with Figure R602.10.5.3. Concrete stem walls shall be 6" nominal minimum thickness. Continuous concrete stem walls shall be reinforced per Section R404.1.2.2.

---

<sup>1</sup> Contact NCDOT for information on the analysis basis for the wall bracing methods specified in this section.

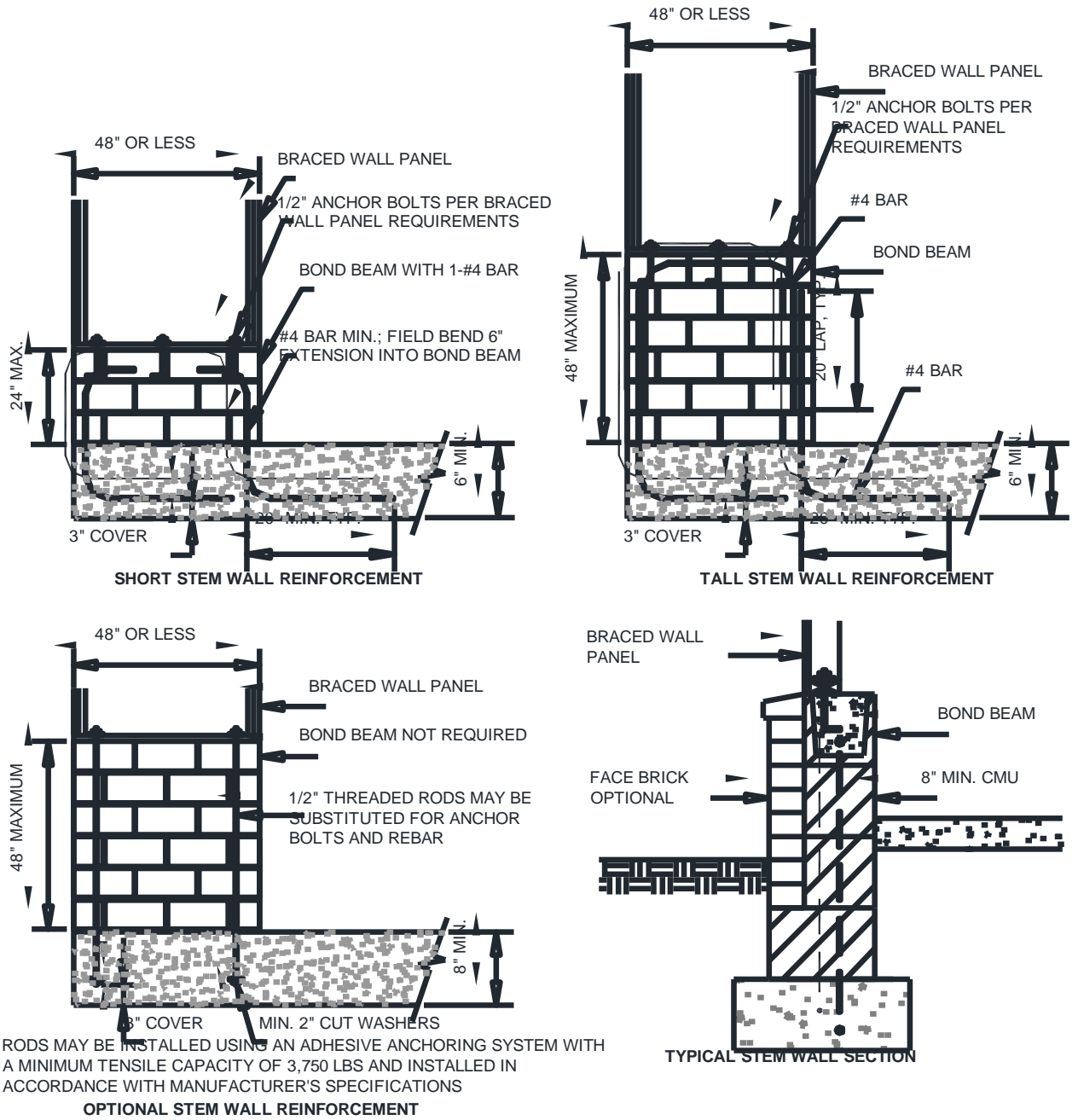

NOTE: GROUT BOND BEAMS AND ALL CELLS WHICH CONTAIN REBAR, THREADED RODS AND ANCHOR BOLTS.

**FIGURE R602.10.5.3 - MASONRY STEM WALLS SUPPORTING BRACED WALL PANELS**



**R602.10.5.4 Blocking of floor framing.** When parallel to floor framing, braced wall panels shall be connected to a band, rim or header joist, floor framing or perpendicular full-height solid blocking between floor framing at 16 inches (406 mm) on center. When perpendicular to floor framing, braced wall panels shall be connected to full-height solid blocking between floor framing. Attachments shall be in accordance with Table R602.3(1). Manufactured lumber or truss blocking panels shall be permitted to substitute for full-height solid blocking.

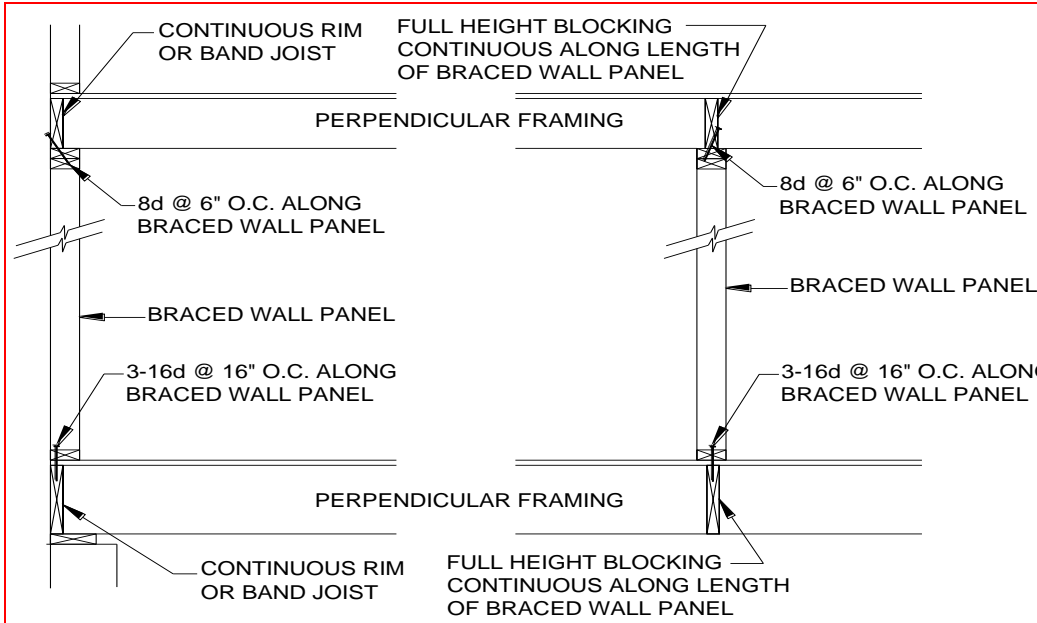

**FIGURE CR602.10.5.4(1)**  
**BRACED WALL PANEL CONNECTION WHEN**  
**PERPENDICULAR TO FLOOR/CEILING FRAMING**

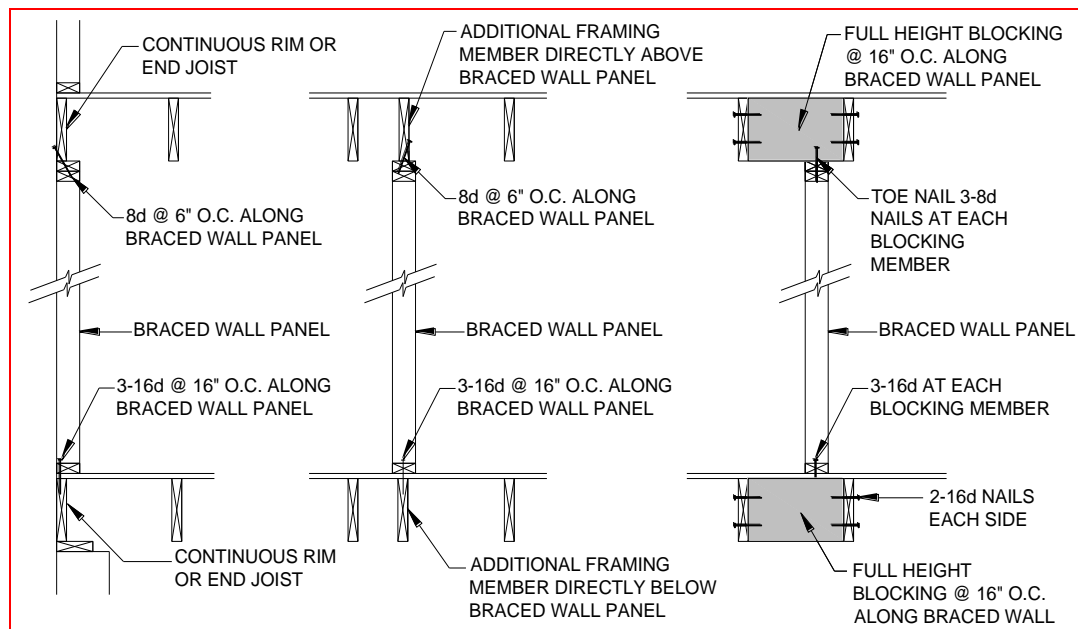

**FIGURE CR602.10.5.4(2)**  
**BRACED WALL PANEL CONNECTION WHEN**  
**PARALLEL TO FLOOR/CEILING FRAMING**

**R602.10.5.5 Blocking of roof framing.** When parallel to roof framing, braced wall panels shall be connected to a band, rim or header joist, or roof truss. When perpendicular to roof framing, the top plates of exterior braced wall panels shall be connected to the rafters or roof trusses above in accordance with Table R602.10.5.5 and fastened in accordance with Table R602.3(1).

**TABLE R602.10.5.5**

**BRACED WALL PANEL CONNECTIONS TO PERPENDICULAR ROOF FRAMING**

<u>DISTANCE FROM TOP OF BRACED WALL PANEL TO TOP OF RAFTER OR ROOF TRUSS, (in)</u>	<u>REQUIREMENT</u>	<u>REFERENCED FIGURE</u>
< 9.25	No blocking required	NA
9.26 – 15.25	Solid 2x blocking between rafters or trusses	R602.10.5.5(1)
15.26 – 48	Vertical blocking panels	R602.10.5.5(2)
> 48	Designed in accordance with accepted engineering practice	NA

For SI: 1 inch = 25.4 mm

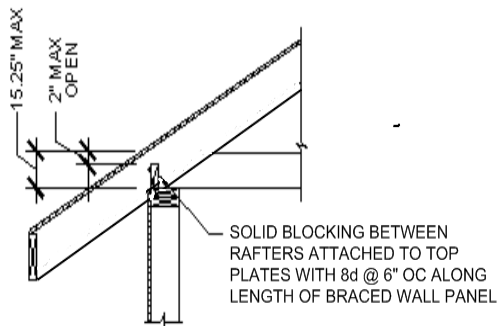

**FIGURE R602.10.5.5(1)**  
**BRACED WALL PANEL CONNECTION TO PERPENDICULAR RAFTERS OR ROOF TRUSSES**

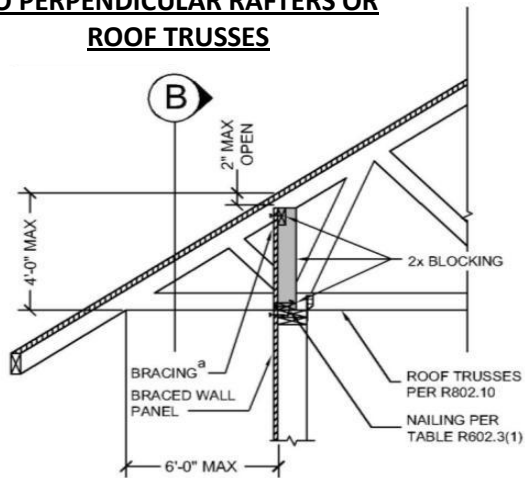

**A** SECTION

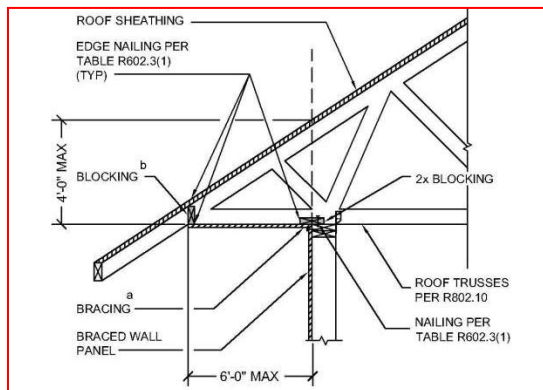

**FIGURE CR602.10.5.5(3)**  
**ALTERNATE TO FIGURE R602.10.5.5(1) OR FIGURE R602.10.5.5(2)**

*Note: Provide ventilation per Section R806*

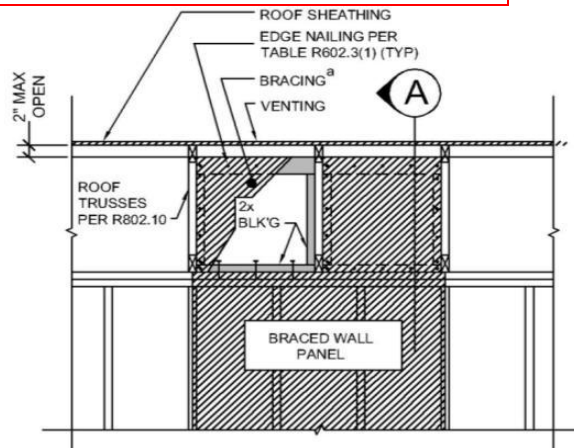

**B** ELEVATION

a. Methods of bracing shall be as described in Section R602.10.1.1

**FIGURE R602.10.5.5(2)**  
**BRACED WALL PANEL CONNECTION TO PERPENDICULAR RAFTERS OR TRUSSES**

**R602.10.5.6 Cripple walls and framed walls of walk-out basements.** The required length of bracing for cripple walls with a maximum height of 48 inches (1220 mm) or less along its entire length shall be equal to the bracing provided for the wall above. The required length of bracing for cripple walls with a height greater than 48 inches (1220 mm) at any location along its length and for framed walls of a walk-out basement shall be determined in accordance with Section R602.10.2 or R602.10.3, considering the cripple wall or walk-out basement as an additional story. As an alternative, the required length of bracing shall be permitted to equal to the bracing provided for the wall above multiplied by a factor of 1.15.

*The above section should not be construed to exclude design by a licensed professional.*

**R602.10.5.7 Open Elevated Foundations.** Open elevated foundations, such as pile foundations, shall be constructed to transfer all lateral loads from the wall bracing system to the piles or open pier system, including shears, overturning, and uplift loads. Piles or open pier systems along with their foundations shall be sized and embedded to transfer all lateral loads imposed by the wall bracing system to the ground.

**R602.10.5.8 Balloon frame wall bracing.** Balloon frame walls shall have a maximum height of two stories and a maximum length of 20 feet unless constructed in accordance with an approved design. Wall framing shall be continuous from lowest floor to the wall top plate at the roof. Braced wall panels shall extend to the full-height of the balloon frame wall. All edges of sheathing shall be supported on and fastened to blocking or framing. The required brace wall panel length assigned to the balloon frame wall shall be based on the bracing required for the lowest floor level supporting the balloon frame wall as determined in accordance with Section R602.10.2 or R602.10.3. For balloon framed walls having a maximum height of two stories and a maximum length of 20 feet (10,160 mm), braced wall panels shall be permitted to be placed both parallel and perpendicular to the balloon framed wall on each side and at each story adjacent to the balloon framed wall, and no bracing shall be required for the balloon frame wall portion. Bracing in the direction perpendicular to the balloon framed wall may be omitted when the opening dimension in the second floor perpendicular to the balloon framed wall created by the two story space is less than one half the least overall dimension of the house. *See Figure CR602.10.5.8.*

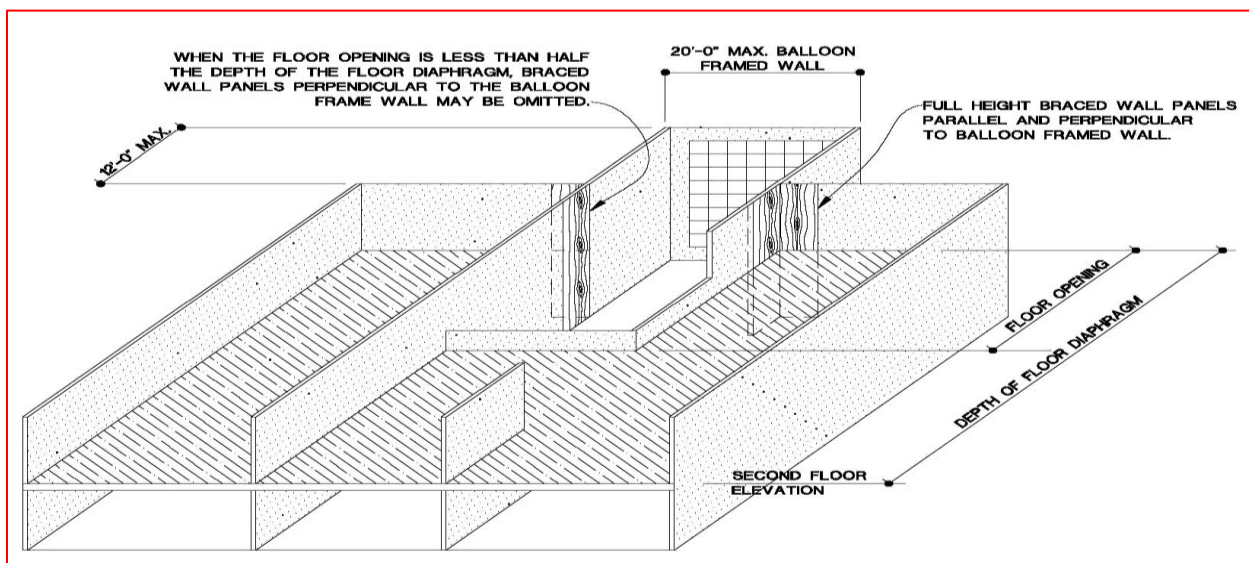

**FIGURE CR602.10.5.8 - BALLOON FRAMED WALL**